

Attention to function & form

Elegant profile

Fabric protection

Optional Remote control

Features Include

The HAROL PR Series are compact folding arm awnings with its own specific contemporary designs. Attention to technical details ensures years of trouble free operation.

The HAROL PR230 has an aluminium extruded casing with strong cast aluminium end covers which encloses the fabric completely providing maximum protection against dirt etc..

The Arms: Extruded aluminium powder coated.

The Hinges: High pressure cast aluminium alloy. Hinge on durable slide bearings of toughened bronze with PTFE sliding layer. Thermally treated.

Springs and Steel cables: Zinc plated high quality spring steel. Grease impregnated Zinc plated steel cables ensure an even division of power.

The Shoulder: Extruded aluminium powder coated. Angle range from 10° to 45°. Design ensures against flapping and dropping of arms.

Sizes:
Maximum- 6 metre in one part with two arms.
- 7 metre in one part with three arms.
- 12 metre in 2 parts with four arms.

Quality: 5 year guarantee. You can therefore expect that only the best materials were used and a high level of importance placed on providing the perfect finish.

Operation: The PR Series can be equipped with electrical operation, using a tubular motor. For the ultimate in comfort an automatic wind-sun sensor regulates the awning automatically, depending on the light intensity and the wind speed. Manual operation using a crank and gearbox is also available.

The HAROL PR230 has an aluminium extruded casing with strong cast aluminium end covers which encloses the fabric completely providing maximum protection against dirt and poor weather.

PR 230



When extended the strong spring assembly in the arms ensures maximum fabric tension is maintained.

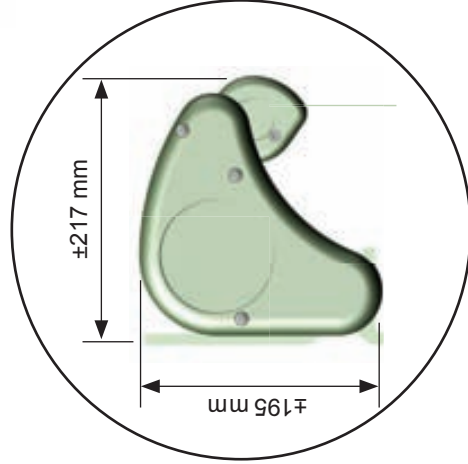

Profile dimensions

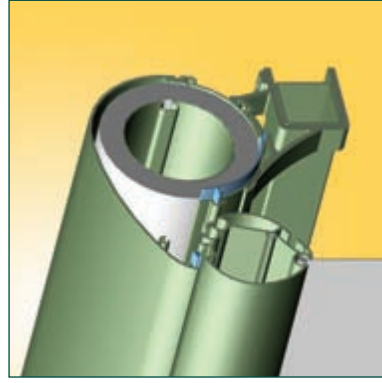

The fabric roller support profile offers protection and support to the fabric.

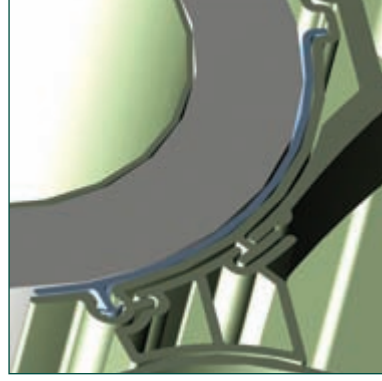

The inside of this profile is clad with a synthetic anti-wear profile for better running and prolonging fabric life.

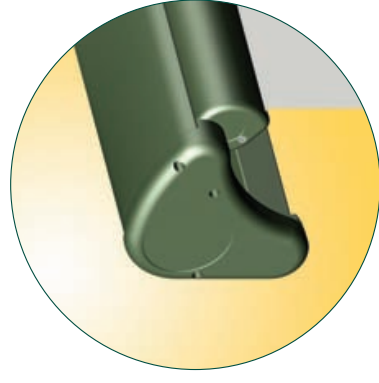

The covers are made of strong cast aluminium and the rounded extension pole is small and compact.